

ELEVATION A-A

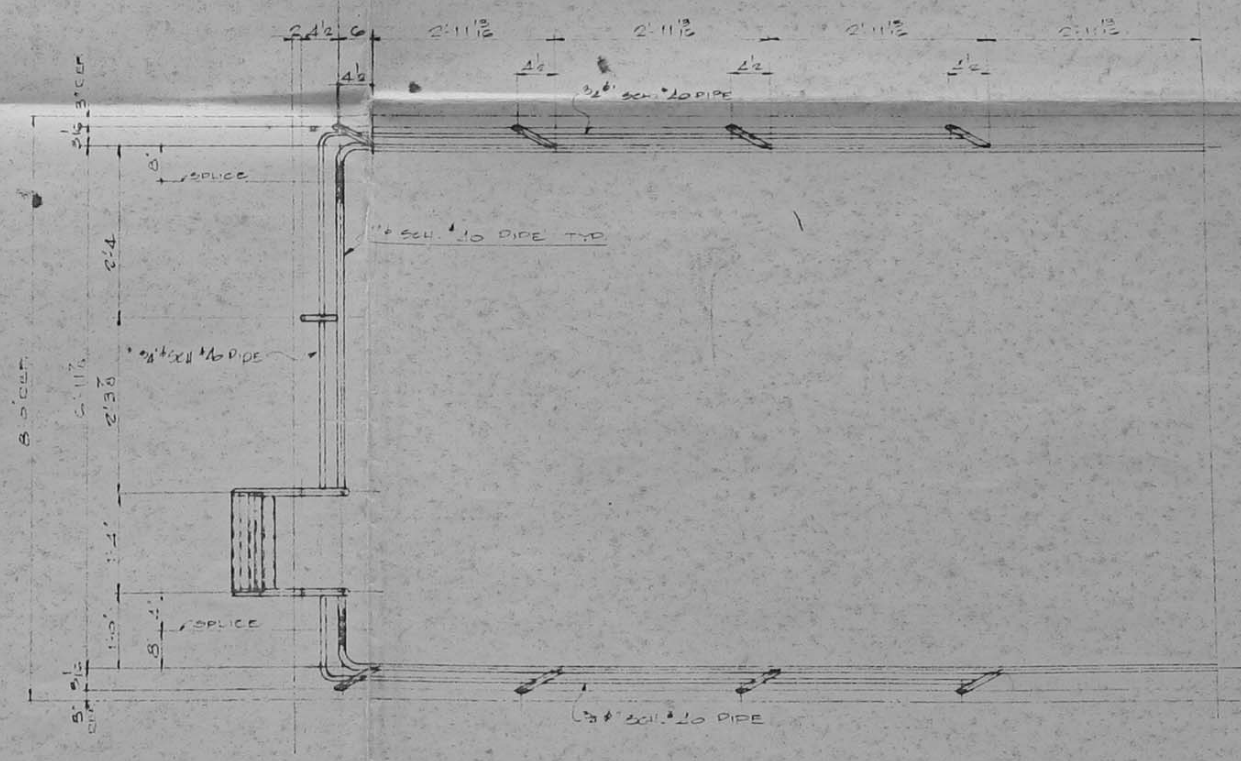

PLAN C-C

ELEV. B-B AS SHOWN
ELEV. B'-B' OPPOSITE

SCALE	1/4" = 1'-0"	ALCAN PROJECT 370
DESIGNED	D. F. LUDER	LEFT CABIN ROOF
DRAWN		HANDRAILING + LADDER
CHECKED		FOR PROJECT DEVELOPMENT DIV.
APPROVED	<i>[Signature]</i>	ALUMINUM COMPANY OF CANADA LTD.
		TAKAPUKIA RD. AUCKLAND, NEW ZEALAND
		PROJECT NO. 1525-007 DATE 27.10.68
		REV. - M-215 ROOF
		A-03-030